

Meridian

Banquet & Conference Center

Phone: 847.952.8181

www.meridianbanquets.com

Fax: 847.952.8722

Welcome to Meridian Banquet & Conference Center

Let us take the worry and hassle out of planning your next company meeting or corporate event. Our professional, courteous and knowledgeable staff will assist you in making your next meeting a successful one. Our comfortable and spacious 2-story lobby allows guests to conduct business as usual. With rooms able to accommodate groups of 50 to 700 and a total occupancy of 1500, our facility is the ideal location for your next meeting or event.

Meridian Overview:

- Near major highways, hotels, entertainment, and O'Hare airport
- Free parking for over 750 cars
- On-site AV equipment & business center with wi-fi access
- Individually appointed soundproof rooms with great acoustics



"As one of the first corporate clients of Meridian Banquets in February of 2002, I knew from the beginning that this was going to be a wonderful partnership. The expert preparatory assistance is easily matched by the superb service receive at the time of our events. Having conducted multiple events at this magnificent facility, as well as personal events, I have always been awed and inspired that every detail is managed so seamlessly.

Patricia L. Murga, Proposal Coordinator, FiserV CBS USA.

SOME OF OUR SATISFIED CLIENTS INCLUDE:

- Northrop Grumman
- NACM - National Association of Credit Management
- FDIC
- ALA
- Northwest Community Hospital

For more information or to schedule a tour please contact:

info@meridianbanquets.com



1701 Algonquin Road

Rolling Meadows, IL 60008

Area Map

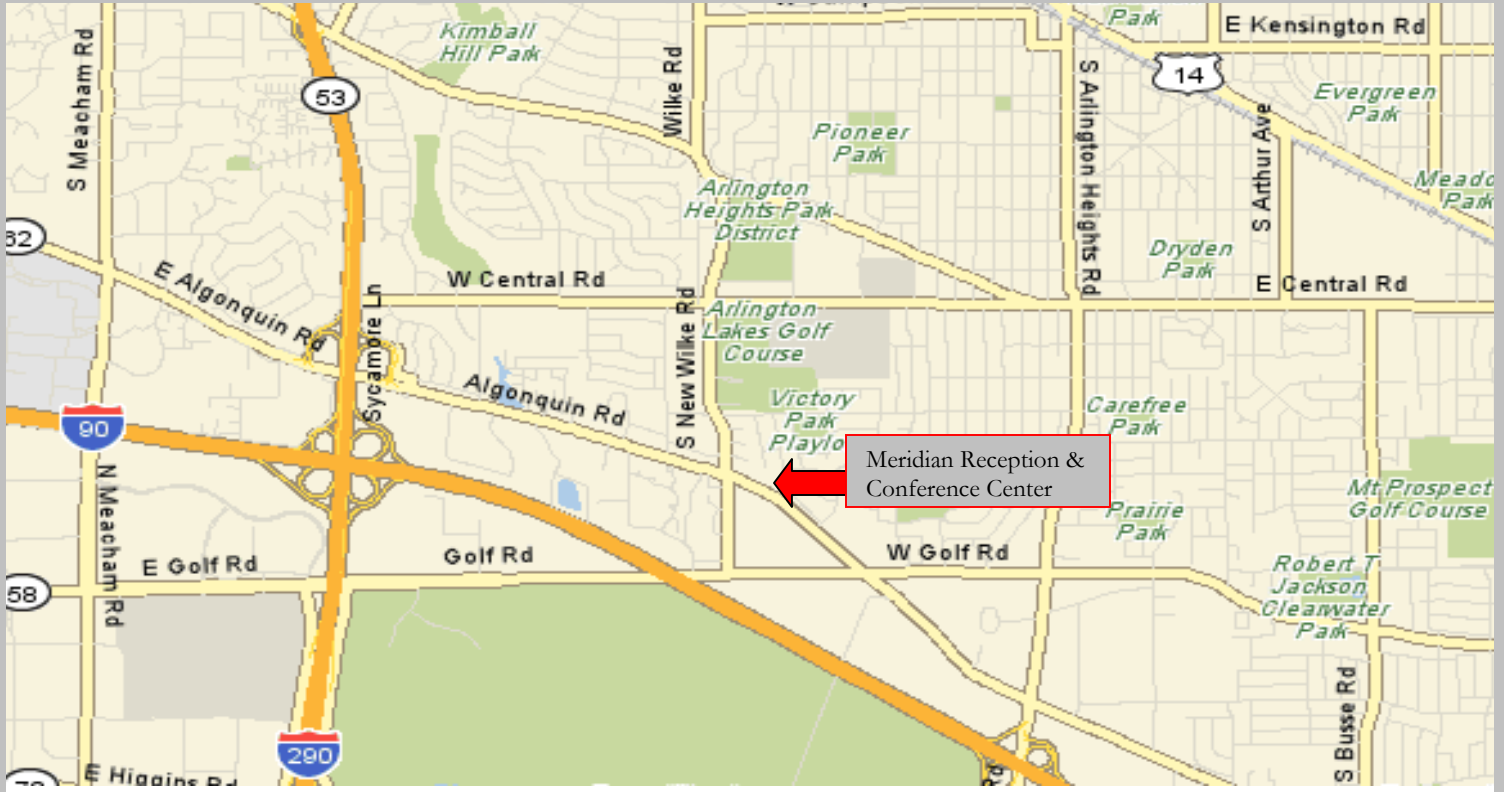

Directions to The Meridian

- Entrances to Meridian Banquets available on both Algonquin Road and New Wilke Road.

From Northeast:

Lake Cook Road, Dundee Road, or Willow / Palatine Road to Rt. 53 south. Exit Algonquin Road east. Travel east on Algonquin Road for about 1 mile. The Meridian is east of the intersection of Algonquin and New Wilke Road.

From East:

Kennedy to Northwest Tollway (I-90). Exit Arlington Heights Road north. Take a left and travel west on Algonquin Road. Travel about 1.4 miles on Algonquin Road to The Meridian.

From Southeast:

Tri-State (I-294) north to Northwest Tollway (I-90) to Rockford. Exit Arlington Heights Road north. Take a left (travel west) on Algonquin Road. Travel about 1.4 miles on Algonquin Road to The Meridian.

From Southwest:

355 north to Route 53 north. Exit Algonquin Road. Take a left and travel east on Algonquin Road for about 1 mile. The Meridian is east of the intersection of Algonquin Road and New Wilke Road.

From West:

Northwest Tollway (I-90) east. Exit Route 53 north. Exit Algonquin Road. Take a left and travel east about 1 mile on Algonquin Road. The Meridian is east of the intersection of Algonquin Road and New Wilke Road.

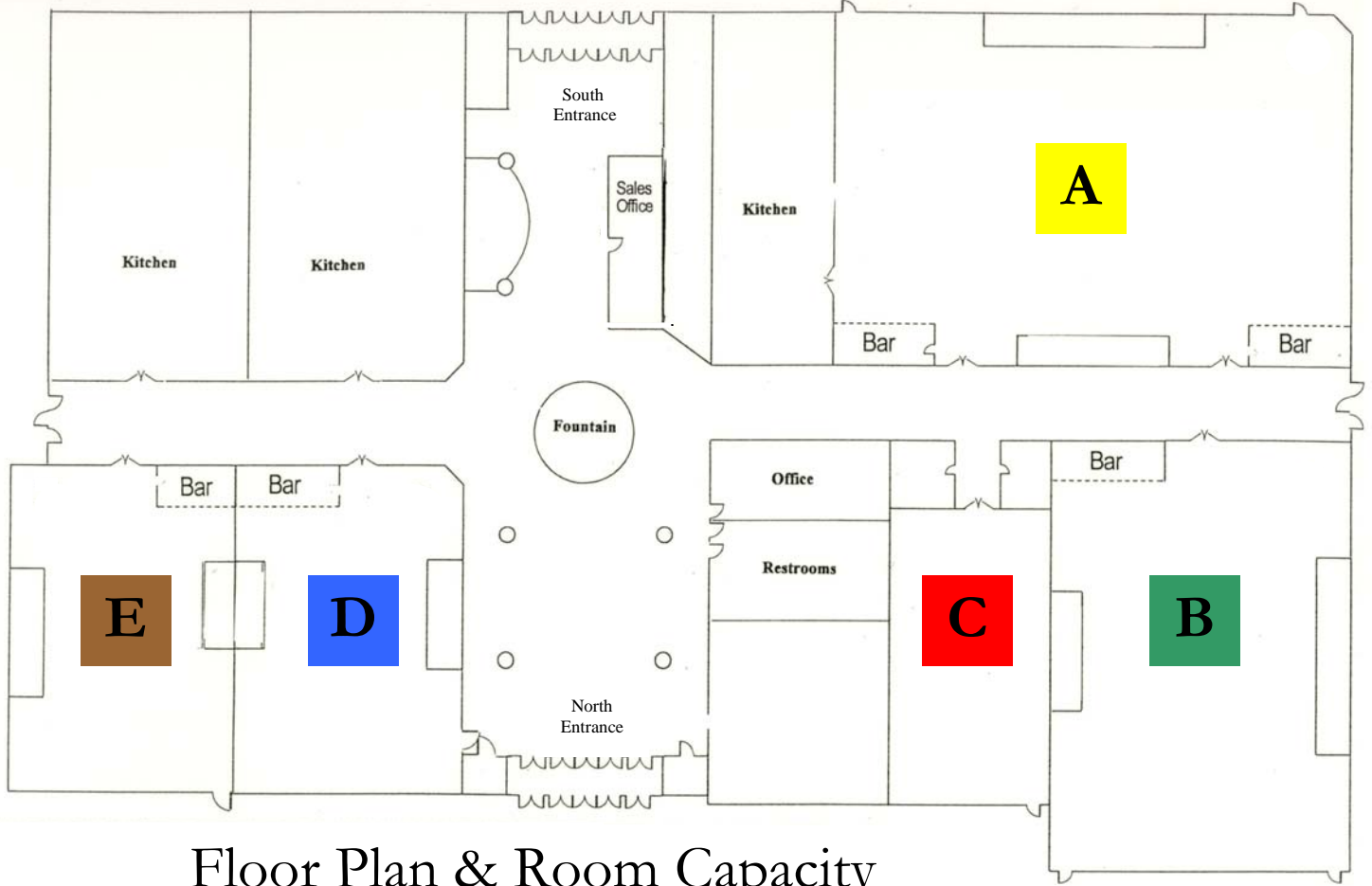

Floor Plan & Room Capacity

Room	Dimensions	Square Footage	Banquet Style Capacity	Classroom Style Capacity	Theatre Style Capacity
A	74 X 109	8,066	500	400	700
B	82 X 63	5,166	300	250	400
C	34 X 61	2,074	120	100	150
D	42 X 68	2,856	120	100	150
E	47 X 68	3,196	160	150	180



Banquet & Conference Center

Phone: 847.952.8181

www.meridianbanquets.com

Fax: 847.952.8722

Corporate Meeting Price List

Room Charges:

Room A.....	\$2,000
Room B.....	\$1,500
Rooms D, E.....	\$1000
Room C.....	\$500

Set Up:

Display Table with Skirting (6x30).....	\$12
Display Table with Skirting (8x30).....	\$14
Staging.....	\$40/Stage

Technical:

Electric Cords.....	\$5
Projection Screen (10x12).....	\$75
Projection Screen (Landscape).....	\$140
LCD Projector (per day).....	\$250
Overhead Projector.....	\$35
TV/VCR Monitor.....	\$75
DVD player.....	\$75
4-channel Audio Mixer.....	\$75
16-channel Audio Mixer.....	\$200
Telephone Line.....	\$35/Line
Internet (per day).....	\$125
Wireless Microphone (each).....	\$75
20' Flat Screen Computer Monitor.....	\$150
Getner Teleconference System.....	\$175
Polycom Teleconference System.....	\$75
Extron RGB H&V Distribution Amplifier.....	\$50
VGA Switcher.....	\$30
Wireless Remote Cue Light.....	\$20
Wireless Mouse.....	\$30
Laser Pointer.....	\$20
Video Camcorder.....	\$200
2 Speaker JBL Sound System.....	\$150
4 Speaker JBL Sound System.....	\$200

1701 Algonquin Road

Rolling Meadows, IL 60008

Breakfast, Break, & Lunch Menu

*Our menu can be customized to fit your specific needs

Continental Breakfast - \$12.00 per person

Includes coffee service, variety of juices, flavored teas, assorted mini muffins, mini croissants, bagels, assorted cookies, and bottled water.

Big Breakfast Buffet - \$18.00 per person

Consists of coffee service, variety of juices, flavored teas, scrambled eggs, bacon & sausage links, French toast, pancakes, English muffins, croissants, assorted mini muffins, sliced fresh fruit, assorted cookies, and bottled water.

AM Break - \$9.00 per person

Regular and decaf coffee, teas, sliced fresh fruits, and a selection of mini pastries

PM Break - \$9.00 per person

Soft drinks, mixed snacks, fresh vegetable crudité's with dips, and bottled water.

Boxed Lunch - \$13.00 per person

*these items served with coleslaw, cookie, sliced fruit, potato chips, & soda

- **Grilled Chicken Breast**
Served on a fresh onion roll with Pesto dressing
- **Ham & Cheese**
With smoked ham and provolone on French bread
- **Roasted Turkey Breast**
With Swiss cheese pesto dressing served on Italian bread
- **Sirloin of Beef**
Served on a Kaiser roll with Swiss cheese and Pesto

Plated Lunch - \$17.00 per person

*includes coffee, soft drinks, rolls & butter

- **Choice of Soup**
- **Tossed Salad with choice of dressing**
- **Choice of Chicken Entree**
- **Choice of vegetable and potato sides**
- **Ice Cream Dessert**

Buffet Lunch - \$20.00 per person

*served with rolls & butter, soft drinks, and coffee

- **Tossed Salad**
- **Pasta Selection**
- **Sliced Sirloin of Beef**
- **Boneless Chicken Breast**
- **Choice of Potato**
- **Choice of vegetables**
- **Assorted Pastries**

Food Station Menu

Carving Station

Slow Roasted Round of Beef with Au Jus
Roasted Turkey Breast with Turkey Gravy

Mexican Station

Mexican Chef Salad
Refried Beans and Spanish Rice
Fresh Chipotle Salsa and Chips
Mini Beef and Bean Burritos

Italian Station

Spinach Cheese Tortellini Alfredo
Ziti Rigate with Marinara Sauce
Italian Sausage and Peppers
Toasted Garlic Bread
Antipasto Salad

Asian Station

Pineapple Chicken Brochettes with Teriyaki Glaze
Crispy Egg Rolls with Sweet and Sour Sauce

Athenian Station

Athenian Salad
Spinach and Cheese Puffs
Pork Shih-Ka-Bobs with Lemon Sauce
Gyros with Tzatziki Sauce with Pita Bread

Sweet Table

Fancy Miniature Pastries
Variety of Sliced Fruit Platters
Mixed Nuts
Coffee Service

Choice of Four Stations

\$35.00 per person

Additional Stations

\$10.00 per person/per station

Service charge included

11.5% sales tax additional

Meridian

Banquet & Conference Center

Phone: 847.952.8181

www.meridianbanquets.com

Fax: 847.952.8722

Wine Service

\$18.00 per bottle

Chardonnay

Cabernet Sauvignon

Merlot

White Zinfandel

Pinot Grigio

Open Bar

We feature a premium top shelf liquor selection to cater to your guests.

One hour = \$12 per person
Two hours = \$15 per person
Three hours = \$18 per person
Four hours = \$20 per person

Please review just a portion of our selection and as always we can customize to fit your needs

Vodka – Grey Goose, Belvedere, Ketel One, Absolute, Effen, Vox, Level, as well as all flavored brands

Bourbon – Jim Beam, Christian Brothers

Scotch & Jack Daniels, Knob Creek, Jonnie Walker Black, Dewars White Label, Chivas Regal, Glenlivet,

Whiskeys Jameson, Crown Royal, Woodford Reserve, Maker's Mark, Canadian Club, Glenmorangie

Rum – Bacardi, Bacardi Limon, Malibu, Captain Morgan, Myers

Gin – Tanqueray, Beefeater, Bombay, Bombay Sapphire

Cognacs – Courvoisier VS, Martell

Tequila – Cuervo 1800, Sauza

Cordials & Liquors – Frangelico, Drambuie, Grand Marnier, Baily's, Campari, Amaretto, Midori, Kahlua

Beers – MGD, Miller Lite, Heineken, Amstel Light, Sam Adams, Corona, Buckler (non-alcoholic)

Cash or Tab Bar

If open bar is not the right option for your event, consider hosting a cash or tab bar. Please review our pricing per drink.

Soda/Juices	\$2.00
Domestic Beer	\$4.00
Imported Beer	\$5.00
Wine	\$4.00
Well Drinks	\$5.00
Call Drinks	\$6.00
Premium Drinks	\$7.00
Cordial/Cognacs	\$8.00
Cosmopolitans/Martinis	\$8.00

1701 Algonquin Road

Rolling Meadows, IL 60008